







Photometrics Calculation Software Generated Luminaire Schedule								
Symbol	Qty	Label	Arrangement	Lum. Lumens	Arr. Lum. Lumens	LLF	Lum. Watts	Arr. Watts
	3	SA	Single	27891	27891	0.900	245	245
	2	SB	Single	20162	20162	0.900	245	245
	3	SC	Single	27809	27809	0.900	245	245
	2	W	Single	4439	4439	0.900	34	34

Calculation Summary							
Label	CalcType	Units	Avg	Max	Min	Avg/Min	Max/Min
PARKING	Illuminance	Fc	3.18	8.8	1.0	3.18	8.80
PROPERTY LINE	Illuminance	Fc	0.13	0.9	0.0	N.A.	N.A.

2851 Dr. MLK Jr. Blvd										
LIGHTING FIXTURE SCHEDULE										
TYPE	DESCRIPTION	MFR	CATALOG NUMBER	VOLTS	LAMP COLOR/TYPE	LUMENS	WATTS	DRIVER	MOUNTING	REMARKS
SA	SITE LUMNAIRE	MCGRAW EDISON	GALN-SA4D-730-U-T4W-FINISH / MA1036-XX	UNV	LED - 3000 K	27891	245	0-10V	POLE	NOTE 1, NOTE 2
SB	SITE LUMNAIRE	MCGRAW EDISON	GALN-SA4D-730-U-T4W-FINISH-HSS / MA1036-XX	UNV	LED - 3000 K	20162	245	0-10V	POLE	NOTE 1, NOTE 2
SC	SITE LUMNAIRE	MCGRAW EDISON	GALN-SA4D-730-U-T4FT-FINISH / MA1036-XX	UNV	LED - 3000 K	27809	245	0-10V	POLE	NOTE 1, NOTE 2
W	WALL PACK	MCGRAW EDISON	GWC-SA1A-730-U-SL2-FINISH	UNV	LED - 3000 K	4439	34	0-10V	WALL	NOTE 1
FIXTURE SCHEDULE NOTES										
NOTE 1: ADVISE FINISH										
NOTE 2: FIXTURES MOUNTED ON 20' ALUMINUM POLE 1908- 30505TE-P2-COOPER FINISH. POLE SPECIFICATION TO BE CONFIRMED PER LOCAL WIND LOAD REQUIREMENTS										
FOR QUESTIONS PERTAINING TO THIS FIXTURE SCHEDULE PLEASE CONTACT STEVE SANDERS AT LIGHTING DYNAMICS #(954) 295-9766; SSANDERS@LIGHTINGDYNAMICS.COM										

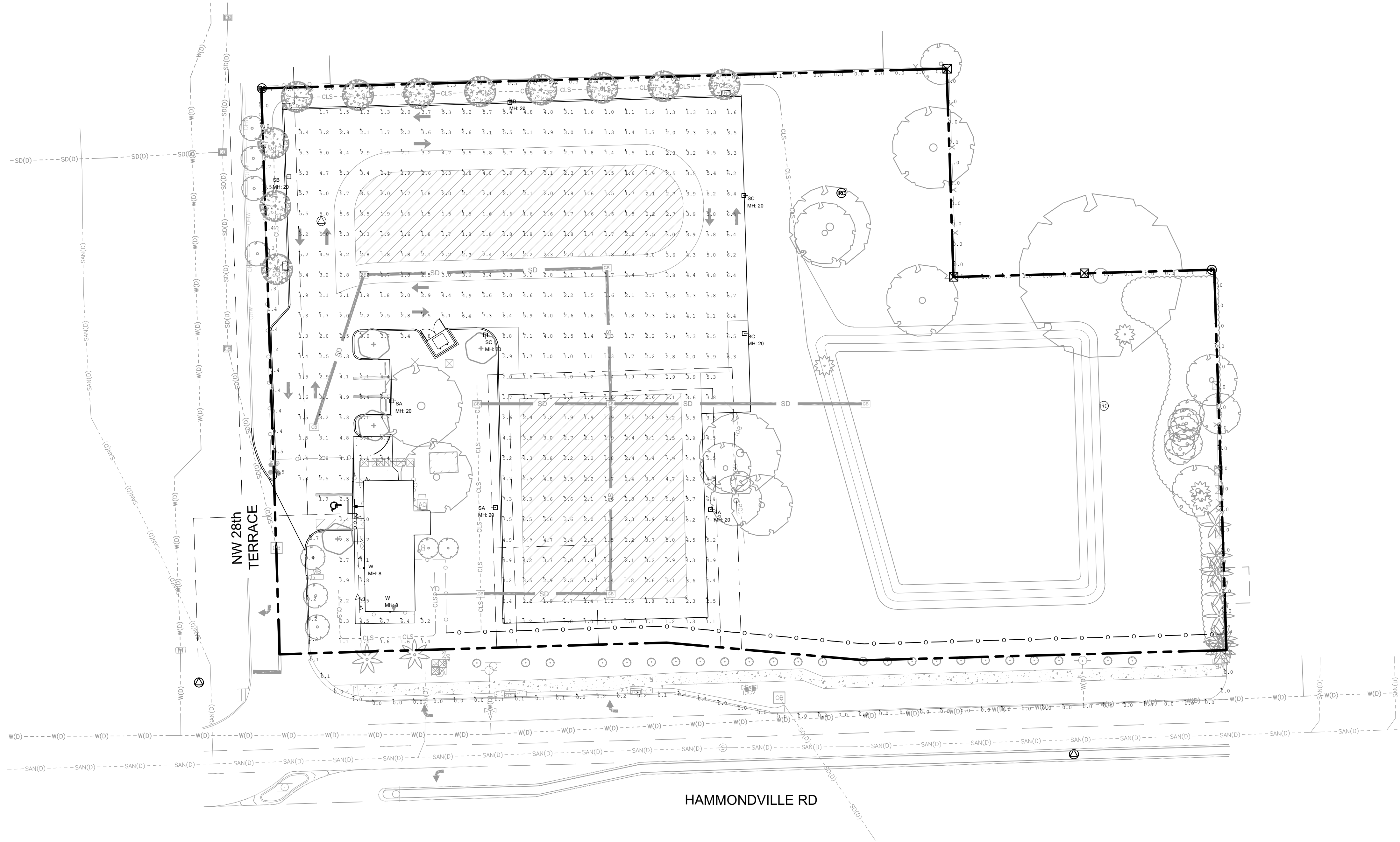

N



GRAPHIC SCALE



SCALE: 1" = 30'

NOTE: PRINTED DRAWING SIZE
MAY HAVE CHANGED FROM
ORIGINAL. VERIFY SCALE USING
BAR SCALE ABOVE.



KEITH
 301 East Atlantic Blvd.
 Pompano Beach, FL 33060
 PH: (954) 788-3400

[illegible]

**RESPONSIBILITY FOR THE USE OF THESE
PLANS PRIOR TO OBTAINING PERMITS FROM
ALL AGENCIES HAVING JURISDICTION OVER
THE PROJECT WILL FALL SOLELY UPON THE
USER.**

ISSUE DATE:	07/30/24
DESIGNED BY:	MP
DRAWN BY:	KU
CHECKED BY:	MP
BID-CONTRACT:	

This item has been digitally signed and sealed by Michael J. Phillips, on the date below using a Digital Signature.

Printed copies of this document are not considered signed and sealed and the signature must be verified on any electronic copies.

2024.07.31 08:35:42-0400

MICHAEL J. PHILLIPS, PLA
FLORIDA REG. NO. LA0001540
(FOR THE FIRM)

CLIENT

**VINCENTO
THROWER, THOMAS
GRANER TRUSTEE**

PROJECT

**2851 DR. MLK JR.
BLVD., POMPANO
BEACH**

SHEET TITLE

LIGHTING PLAN

SHEET NUMBER	LL-101
PROJECT NUMBER	14232.00